

Yurt window design template

This document contains information and a blank template to plan the window and flue positions of your yurt.

Page 2 shows an example plan with windows drawn on at required positions on the clock face.

Page 3 is a blank template. You can print this page, add your design, then scan or photograph it and return to us via email.

If you don't have a printer you can draw your own circle and add your windows and flue.

Detailed measurements in mm can be added to your plan if you need more precise positioning than hours or half hours etc.

Alternatively you can describe the layout to us e.g "rectangular opening window at 4 O'clock" etc

Useful measurements				
	4M Yurt	5M Yurt	6M Yurt	7M Yurt
Total Circumference	12804mm	15638mm	18876mm	22115mm
Distance per hour	1067mm	1303mm	1573mm	1843mm

Available window sizes

- Windows can have a maximum height of 1200mm which will start from 250mm above the ground and extent to a height of approx 1450mm.
- Windows can start higher up from the floor e.g 900mm up to go above a bench top.
- Opening windows have a standard width of 1200mm. Non opening windows can be of any width.

Maximum and Minimum Window area for consents

To meet thermal performance and natural light requirements for permit applications, there are maximum and minimum window areas required.

	4M Yurt	5M Yurt	6M Yurt	7M Yurt
Max window area	4 m2	5 m2	6 m2	7 m2
Min window area	2 m2	2.5 m2	3 m2	3.5 m2
Below values are based on windows of maximum height (1200mm)				
Max total window width	3300mm	4150mm	5000mm	5800mm
Min total window width	1650mm	2075mm	2500mm	2900mm

Example design

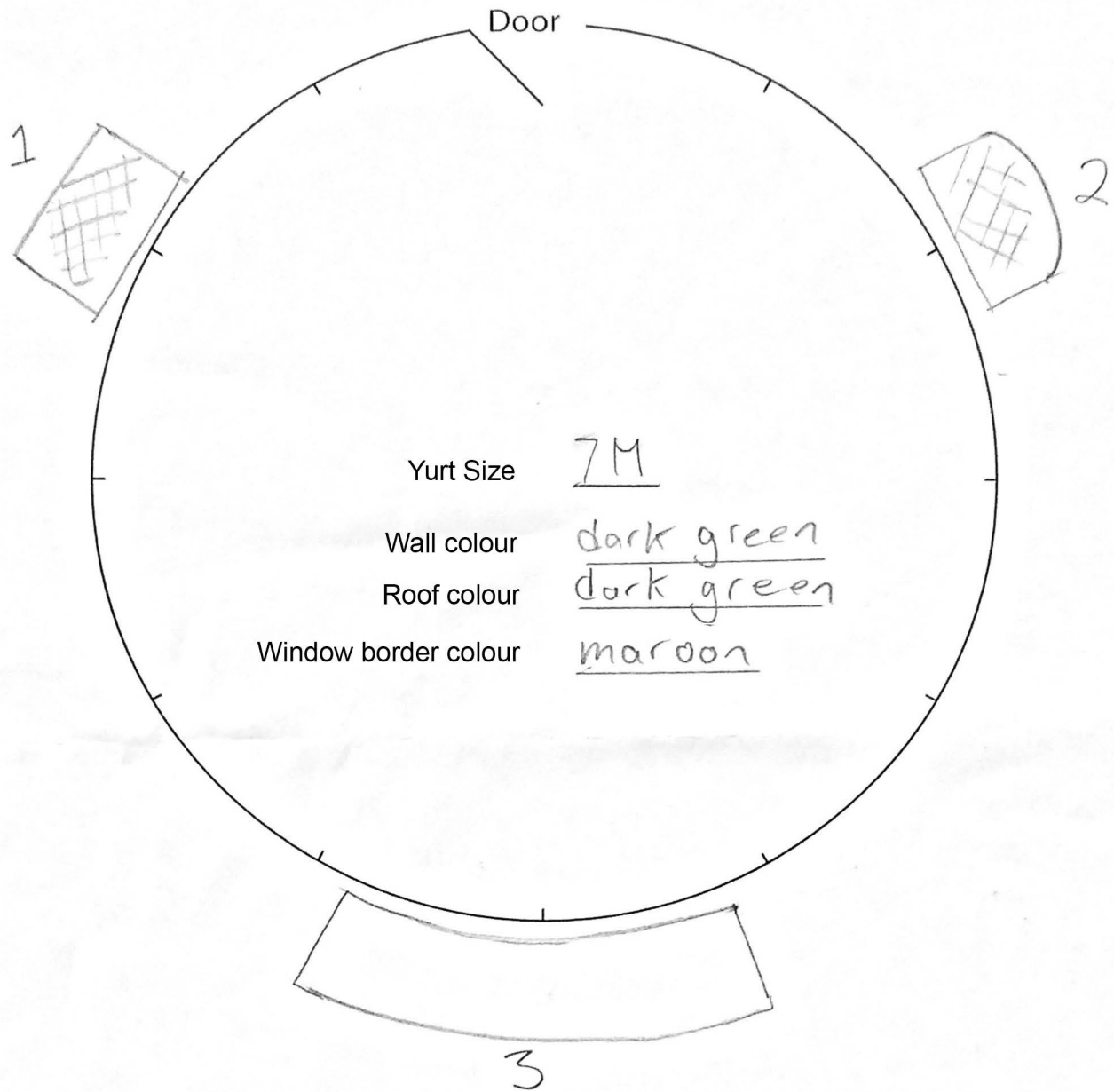

- window 1 - rectangle opening with bug screen
- window 2 - arched opening with bug screen
- window 3 - 3m wide rectangle, non opening

My Yurt Design

